

Specification and information for Active composite doors

DOOR LEAF COMPOSITION

The inner and outer skins are manufactured from vacuum formed 1.5mm thick modified polycarbonate sheet called Compax. The Compax skins are UV stabilised and are self-extinguishing once the flame has been removed. (Class 1 Surface Spread of Flame BS476 Part 7). When vacuum formed, the Compax skins have a Woodgrain effect finish.

The leaf core consists of a solid 41mm sub frame made of "Kerto q (Ivl)", tested to BS476: part 22 1987, accredited with BBA 00/3717 and compliant with ISO9001 & ISO2000 requirements.

The inner core consists of machined 41mm type A expanded polystyrene, containing a fire retardant additive specially formulated to restrict the extent of burn when tested to BS4735. The polystyrene is classified under BS476 and is totally recyclable, on toxic and inert containing no CFC's or HFC's.

The skins are bonded to the core using a moisture-cured adhesive.

The edge of the door leaf is fully sealed with a 1.5mm ABS edge band. The adhesive used is a moisture resistant hot melt.

GLAZING

All sealed units are 28mm thick and are manufactured with toughened safety glass. The sealed unit is glazed into the door using a glazing cassette system. The cassette is pre-finished to match the door.

OUTER FRAME

The outer frame is manufactured from 70mm deep (Rehau S706) profile and is fully welded and reinforced with galvanised steel. Rehau is BBA approved and manufactured to BS7413.

The external seal on the outer frame is a rubber flipper gasket & is available in black or white. The internal seal is Schlegel brush pile PB691300.

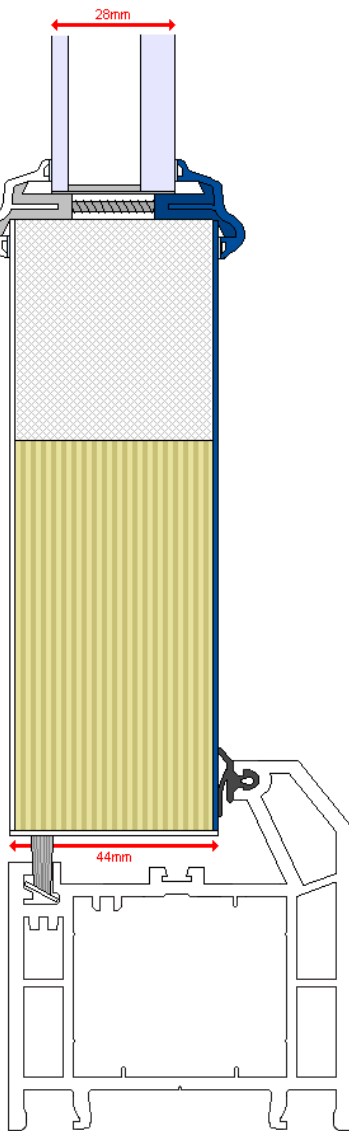

DOOR HARDWARE

The locking system is a Winkhaus Trulock multi point lock. This consists of a top and bottom hook bolt, centre latch and deadbolt. There are 3 laterally adjustable keeps.

The door leaf is fixed to the frame with 3 butt hinges. They have lateral, vertical and compression adjustment. A High security pin and locking screw are incorporated into the hinge. The door handles conform to BS7412 clause 4; die cast alloy to BSEN 12844, steel parts to BS970 part 1. The door handles are salt spray tested to withstand 240 hours.

The door leaf is fitted with a weather bar deflector manufactured by Exitex.

LOW THRESHOLD

The door frame can be supplied with a 150mm external cill.

A Part M compliant aluminium mobility threshold manufactured by Exitex can be fitted if required.